

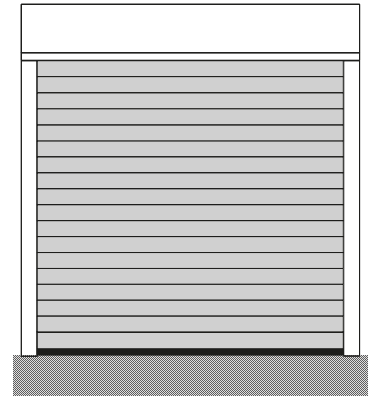

DECEMBER 2022 V1



ThermaRoll Roller Garage Door Installation Guide For residential doors



IMPORTANT - AVOIDING UNNECESSARY CALL-BACKS

Our objective is for no unnecessary call-backs to site to rectify an issue. The points below highlight the most common avoidable issues. Please take these on board to ensure a positive installation experience with no call-backs!

Crushed Bottom Seal – If the door limits are set to drive the seal hard down against the threshold, over time, the seal will become permanently compressed, compromising the safety systems contained within the rubber seal. As a result the door will go up but won't come down and a call-back will result. The condition of the threshold is an important factor. It must be smooth and level. The seal should sit on the threshold with sufficient compression to make good contact but no more. The seal is not designed to overcome a poor threshold and issues of this type will not be considered warranty.

Curtain Marking – Over time your ThermaRoll door will attract dust, dirt and other contaminants that will cause marking to both sides of the curtain as the door rolls up and down on itself. Marking to both sides of the door is normal and not considered a product defect. This does not impact the performance of your door and is not considered warranty.

All roller doors require periodical maintenance as set out in the care and maintenance guide and this can help limit marking due to dirt and debris. This is especially relevant if you live in a coastal region due to salt corrosion or if your door is installed in an environment where it will attract a lot of dirt/dust/sand contaminants. Examples are; doors in front of pavers with sand infill, new build development sites and gravel yards. Environments of this kind are prone to casting a lot of contaminants on to the door, particularly when it is wet and windy. As the door operates these contaminants transfer onto both sides of the door as it rolls up and down and causing scratching. These marking are not deemed warranty. To limit the occurrence, open up the door curtain joints by partly opening the door and wash the door correctly as per the care and maintenance brochure.

Unsupported Boxes – This is most important for in-between and under installations but also where there is partial protrusion of the box below the lintel. The box, and in particular the 90° section, even with box reinforcements fitted, will flex if unsupported. The flexing will result in contact with the door curtain and result in significant marking of the curtain. This will increase as the box flexes back and forth in windy conditions.

The 90° face of box should always be supported where possible in its entirety. We recommend no more than a 100mm section of any box is unsupported due to the risk of curtain marking. Any unsupported box resulting in curtain marking is not deemed warranty. See page 29 for tips on preventing curtain damage.



ThermaRoll Roller Garage Door Installation Instructions For residential doors

CONTENTS

Important Information – Warnings & Safety Obligations	Page 3
CE marking, Operating & Warranty	Page 4
Pre-Installation Checks	Page 5
Component Check / Assembly Parts / Tools / Recommended Fixings	Page 6
Setting out your Installation	Page 8
Full Box	
Half Box	
No Box	
Guide Preparation	Page 10
Guide Rails & Axle Assembly	Page 11
Endplate plate Preparation, Guide & Endplate Fixing	Page 13
Manual Override Fitting	Page 14
Installation of Curtain into Guides & Stop Fitting	Page 14
Installation & Connection of Board, Motor Direction	Page 15
Attachment of Curtain to Axle	Page 20
Commissioning and Setting Somfy Motor Limits	Page 21
Setting Econom Motor Limits	Page 22
Additional Rollixo Set Up and Connecting Additional Devices	Page 24
Measures to Prevent Curtain Damage!	Page 29
Troubleshooting Guide	Page 30



IMPORTANT INFORMATION WARNINGS & SAFETY OBLIGATIONS

- Your safety, your end user's safety and that of the general public is our primary concern. Please read, understand and follow our advice.
- These installation instructions are intended for qualified and trained installation engineers.
- Installation, initial operation, servicing, repairs and dismantling of this product should only be carried out by a qualified and trained installation engineer.



WARNING!

Failure to comply with these instructions invalidates the warranty.

Before you begin the fitting of the door, read and fully understand all of the instructions thoroughly.

WHO SHOULD INSTALL THIS DOOR?

A minimum of two people must be available for fitting.

GDS recommend that fitting and/or repair of garage doors be performed by a qualified, factory trained garage door specialist.



SAFETY EQUIPMENT

Goggles
Safety Shoes
Gloves



GENERAL NOTES

These doors meet all relevant safety requirements when installed according to these fitting instructions.

Both one and two car doors are installed in the same manner.

Damage to the garage door due to improper handling, installation or improper adjustment of the electric operator is not covered by Garage Door Systems' warranty.

Be sure all warning labels and tags are properly affixed to the door and that the home owner is familiar with the door operation.

Before removing the old door or unpacking the door, confirm the opening dimensions to ensure door will fit.



IMPORTANT INFORMATION

CE MARKING, OPERATING & WARRANTY



CE MARKING

- To comply with the Machinery Directive both the door and the motor and controller used in the installation must have a Declaration of Performance from the manufacturer.
- On completion of the installation the installer must provide a Declaration of Conformity and apply a CE mark giving details of the installations to the door/motor and controller combination, which is now classed as a machine.
- The installer must issue to the customer a Declaration of Conformity and operating and maintenance instructions on completion of the installation.
- The installer must hold copies of both the Declaration of Performance and the Declaration of Conformity on a technical file for inspection by the relevant authorities.
- If any of the above requirements are not fulfilled, the installation is illegal.

GENERAL OPERATING INFORMATION

Upon completion of the installation the end user of the door must be trained how to operate the product safely paying particular attention to the following points;

- The door should only be operated when in view.
- The end user must ensure there are no objects or persons in the opening before and during operation.
- The end user must read and follow the instructions given in the operating and maintenance instructions.
- In the event of a malfunction the end user should follow the instructions given in the operating and maintenance instructions and if required contact the installer.
- It is the end users responsibility to maintain a regular and appropriate service and maintenance schedule.

RECOMMENDED SERVICE PERIOD

The recommended service period for a ThermaRoll door that will operate on average two cycles per day is once every 12 months or as a minimum once every 24 months to maintain the products warranty requirements.

WARRANTY/LIFE CYCLES

- The installation must be carried out by a competent installation engineer following these instructions.
- Only original parts are used.
- No additional objects are attached to the door.
- Regular and appropriate maintenance checks are performed.
- For further details on the product warranties please contact us.



PRE-INSTALLATION CHECKS

STRUCTURAL CONDITIONS

- Ensure finished floor surface is in place before installing your ThermaRoll door.
- Ensure there is adequate sideroom and headroom.
- The jambs and head should be on the same plane.
- The jambs must be plumb, and the header level for a true opening. Small irregularities in the brickwork are acceptable as long as they do not interfere with proper fitting of the door guides or optional boxes.
- The surface where the door is to be fitted must be strong enough to support the door.
- The door should be fitted only after any plastering of the area has been completed. Plaster splashes may damage the door finish and interfere with proper operation.
- Before unpacking your door confirm opening measurements as well as headroom and side room clearance to ensure door will fit.
- Ensure that the site is clear and that all fixing surfaces are free from loose plaster or masonry. Ensure the opening has no irregularities that could damage or mark the box or curtain.



CHECK!

ENSURE THAT THE AREA AROUND THE OPENING IS STRONG ENOUGH TO SUPPORT THE DOOR

Check:

- Structure is sound and even and can carry the weight of the door.
- No obstacles in fitting footprint e.g. no sharp objects, pipes, cables, bumps etc. sticking out from the pillars, lintel or header to twist the guides, distort the fascia or catch on the curtain.
- Floor is flat and level.
- If necessary install a sub-frame to ensure secure, flush and level fixing (Recommended minimum 70 X 70 PAR).

RECOMMENDED FIXINGS (NOT SUPPLIED)

12 x 2.5" coach screws for wood and coach screws and plugs for Masonry.

12 x 1" self tapping screws for steel.

TOOLS REQUIRED FOR INSTALLATION



Tape measure



Stanley knife



Pencil



Spirit/laser level



Adjustable spanner



Allen key set



Quick clamps



Spacers/wedges for frame setting



Masonry drill/bits



Electric drill



Bits



Pozidrive screw drivers



'A' rated steps x2



THE PACKED DOOR

The door curtain will be fully packaged when delivered, if a box option has been ordered the headplates will be factory fitted to the box and will have the curtain packed and rolled inside.

Two packages.



The door box and door curtain roll.

The door barrel, guides and hand crank.

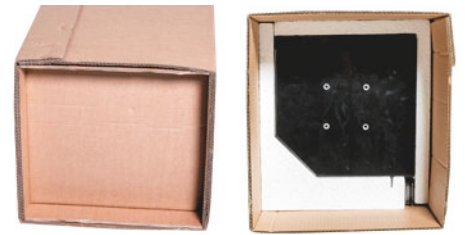

A full box door unwrapped.



The control box is packed in the end of the door box package.

The wrapped curtain is shipped inside the door box for full and half box doors.



The 90° half box shown with stiffeners (fitted as standard to all doors 3m+) and the curtain lifted clear.

somfy Building happiness

INCLUDES:

- Somfy Control Box
- Manual Hand Crank Override Direction Label
- Power Cord
- LED Bulb
- 2 x Keygo Transmitters
- Guide Bungs
- Information Label for Fixing to the Guide
- Cable Grip
- Screws for Mounting Board



Doors with no roll box have the end plates at one end of the package.



The wrapped barrel, guides and hand crank unwrapped below.

THE COMPONENTS

1. Somfy Control box.
2. Crank handle.
3. Knuckle override.
4. Lock strap pins and end plate and knuckle override fixing screws (in shrink wrapped pack, attached to barrel).
5. Guide Rails 70mm or 100mm with brush inserts fitted.
6. Curtain with bottom slat, factory fitted wired safety edge/spiral cable and direct connect locking straps.
7. Curtain endlocks (pre-fitted).
8. Left hand endplate.
9. Right hand end plate.
10. Barrel assembly with lock rings, pins, safety brake and motor.
11. Motor end.
12. Non-drive end with safety brake.
13. Optional 90° half box - pre-fitted to end plates
14. Optional 45° full box.

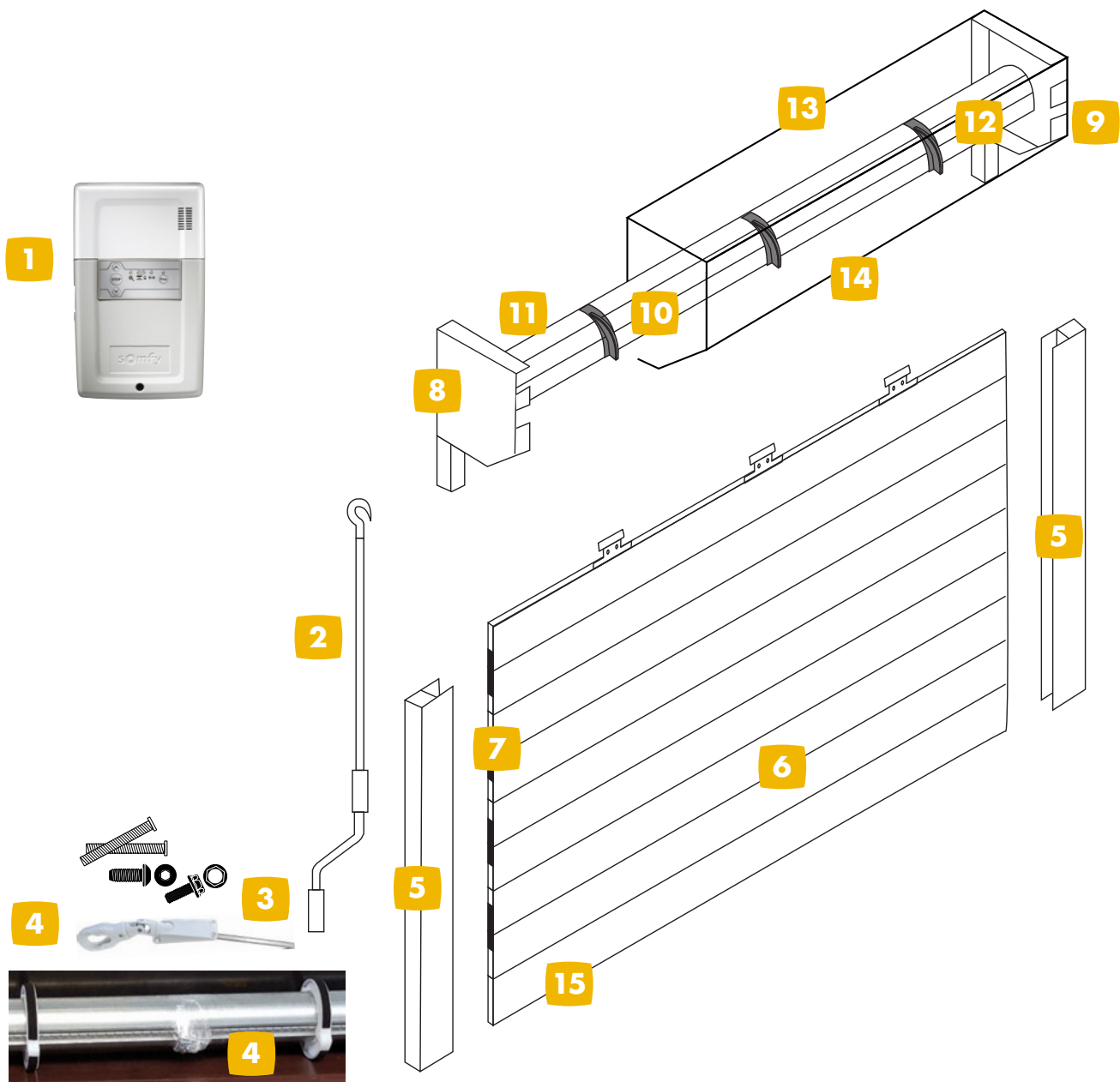

Lock strap bolts, motor headplate mounting screws and knuckle override and fixings pack is wrapped onto the barrel (8 self tapping screws for the motor headplate and 4 fixings for the knuckle override).

SETTING OUT YOUR INSTALLATION

FULL BOX & HALF BOX

If your door has been supplied with an optional Full or Half box assembled your overall size is pre-set. Put cardboard protection down first. Place box on the floor against the opening where the door is to be fitted, ensure overlap is equal on each side and mark a plumb line 'A' up each wall at the outside edge of the box.

This is your outside edge of guide mark.

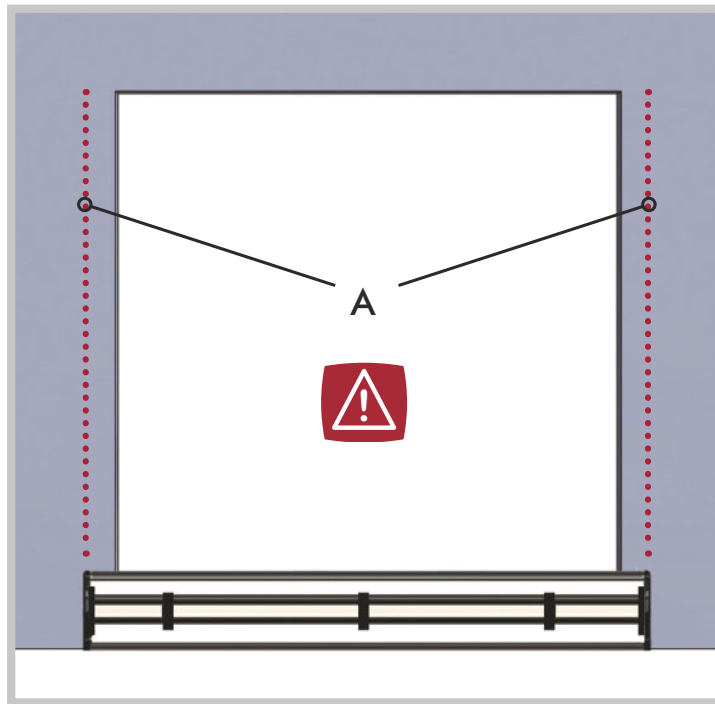

IMPORTANT – FLOOR IS FLAT AND LEVEL

Fit base of guide level with the highest point of the floor surface

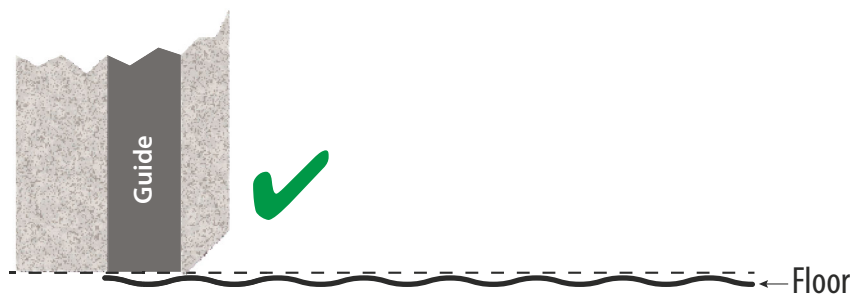

DO NOT fit guide in recess left by removal of timber frame

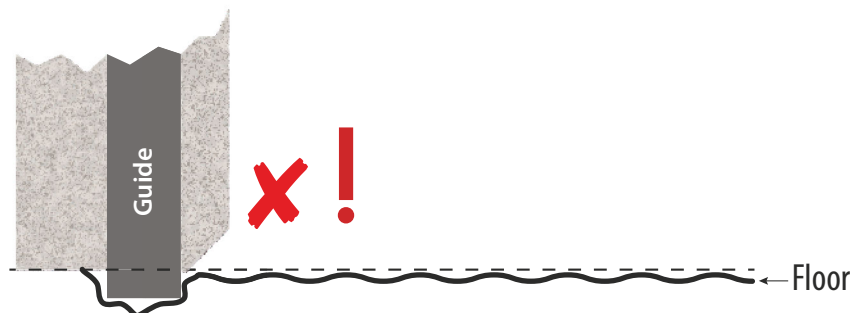

SETTING OUT YOUR INSTALLATION

NO BOX

Guides are 70mm or 100mm depending on door size.

Endplates and the control box will be packed with the curtain. The barrel assembly, including motor and fixing plate at one end and safety brake at the other, will be packaged with the guide rails and crank handle.

To determine the over-guide width you must measure the width of the door curtain (width does not include the plastic end locks).

Once you have determined the curtain width add 100mm to give you the over-guide width.

Deduct the opening width from the over-guide width and divide by 2 to determine the outside edge position of the guide from the edge of the opening.

Mark a plumb line 'A' up each wall at this point. This is your outside edge of guide mark.

Example: End locked Curtain

(based on 2000mm opening width & internal face fix)

Door curtain width / cut slat dimension (exclude plastic end locks when measuring)	2040mm
+100mm to above dimension	+100mm
(This is your overguide width) TOTAL	2140mm
Opening Width	2000mm
Overguide width 2140mm - opening width 2000mm = TOTAL OVERLAP	140mm
TOTAL OVERLAP / 2 = outside edge of guide from edge of opening	70mm

Worksheet: End Locked

Door curtain width / cut slat dimension (exclude plastic end locks when measuring)	mm
+100mm if end locked curtain	+100mm
+92mm if webbed curtain	+92mm
(This is your overguide width) TOTAL	mm
Opening Width	mm
Overguide width ____ mm - opening width ____ mm = TOTAL OVERLAP	mm
TOTAL OVERLAP / 2 = outside edge of guide from edge of opening	mm

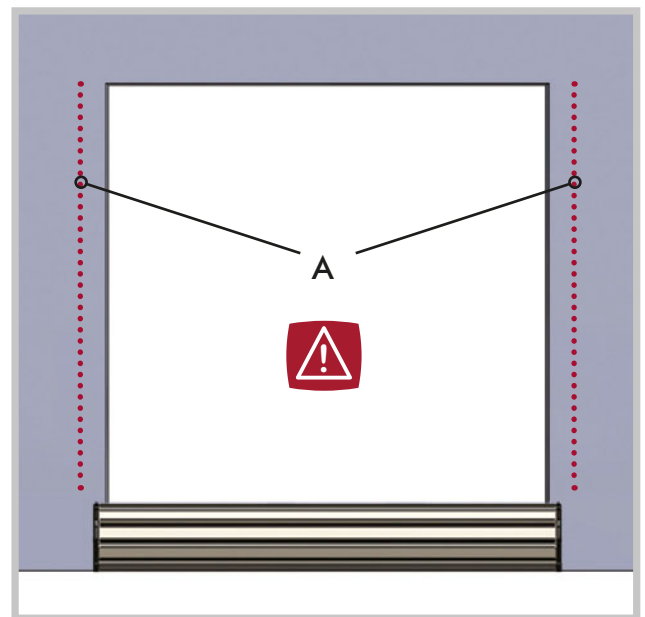

GUIDE PREPARATION

The guides should be unpacked and placed either side of the opening. The guides are designed with spacing lugs inside the box to ensure that the guide is a good fit to the head-plate. Ensure that the guides are the correct way round. See Fig 1.

As a further aid to alignment the 25mm saw cut in the guide should be oriented as shown

GUIDE ORIENTATION

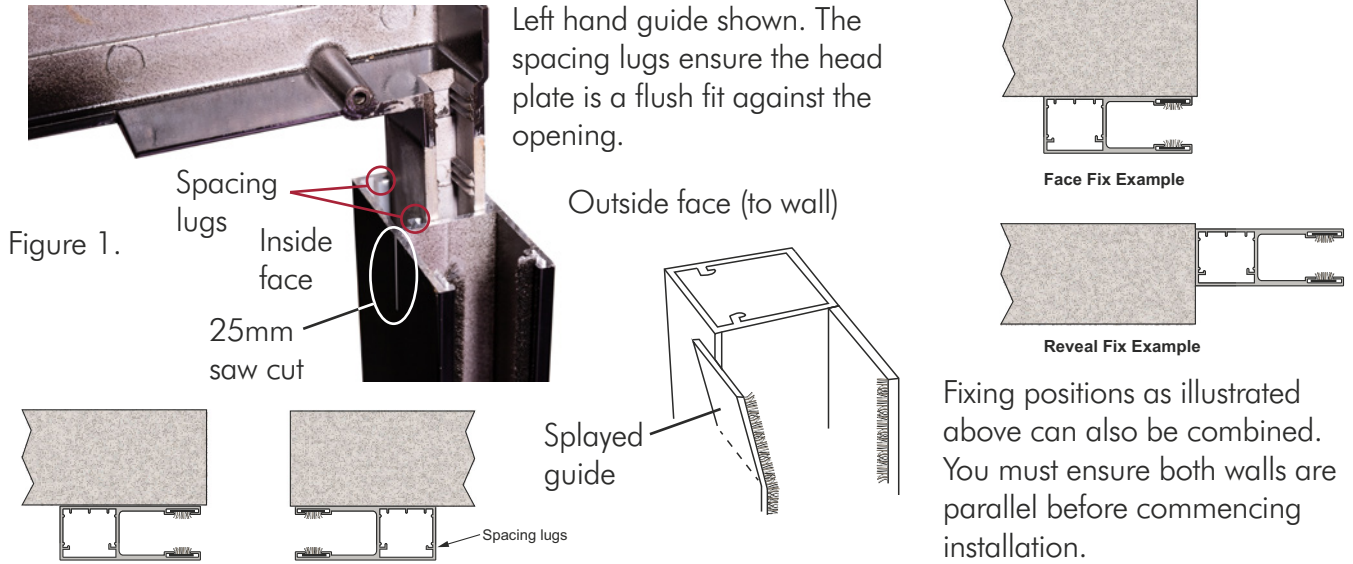

GUIDE FIXING HOLES

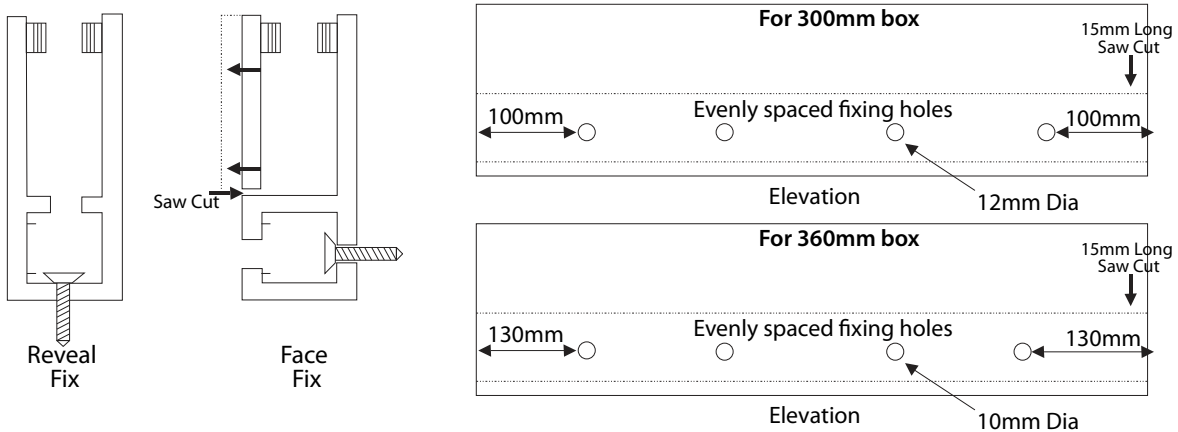

On 300mm head plate Drill 7mm fixing holes through the guide channel box section starting 100mm from the bottom and space evenly thereafter, your last hole should be 100mm from the top of the guide.

On 360mm head plate Drill 7mm fixing holes through the guide channel box section starting 130mm from the bottom and space evenly thereafter, your last hole should be 130mm from the top of the guide.

Note which face of the guide is to be fitted to the wall (Spacing legs and or the saw cut away from fixing wall). Now enlarge the fixing holes to 12mm* on the Inside face of the guide section to allow access to the fixings and accept the hole cover grommets.

*Guides are supplied with black grommets – Drill 12mm hole.

To assist the smooth operation of the garage door a 25mm saw cut has been made at the top of both guide sections on the internal face, and the guide should be splayed creating a funnel below the nylon idler wheel on the head plate.

AXLE ASSEMBLY

The barrel is held in place by a motor mounting plate on the motor end of the barrel and a safety brake on the non-drive end of the motor barrel. The motor mounting plate is pre-fitted to the motor and the safety brake is pre-fitted to the endplate.

The non-drive end of the barrel has an adjustable shaft which is held in place by a No.5 tensile Allen bolt.

NOTE: If the optional 90° box has been ordered, you can install the barrel into the head plates before lifting into position.

(1) Using a Pozi screwdriver loosen the locking collar screw on the non-drive end, allowing the shaft to move in and out of the barrel tube freely.

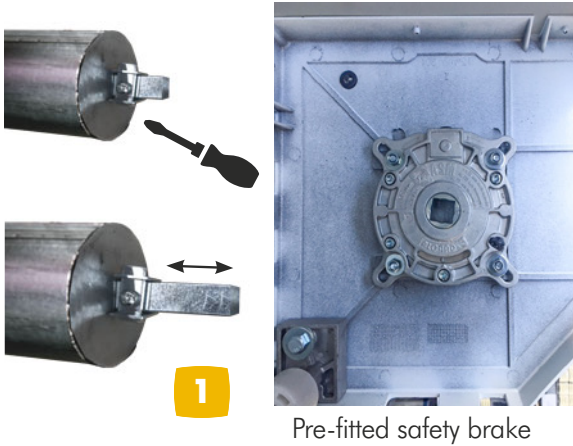

Pre-fitted safety brake

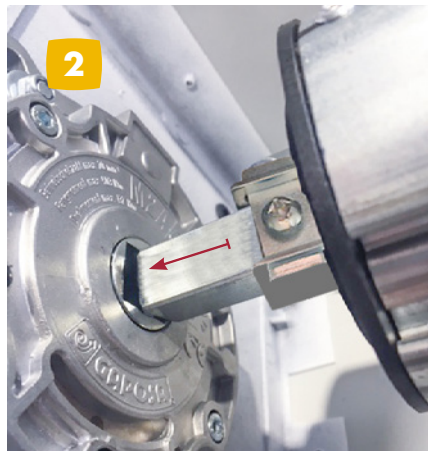
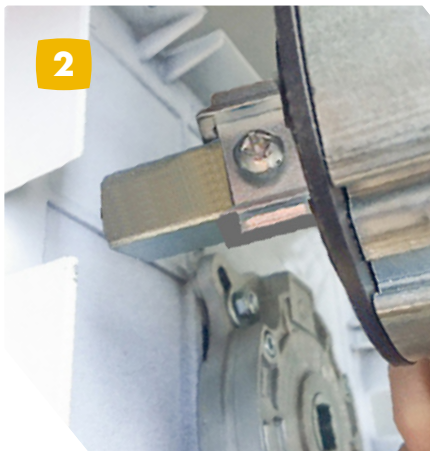

(2) Lift the barrel into position and fully engage the non-drive end shaft into the safety brake.

(3) Ensuring the motor mounting plate at the drive end is hard against the endplate tighten the locking collar screw to secure the non-drive end.

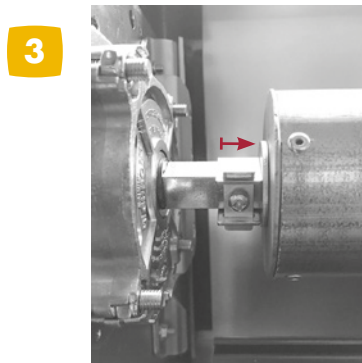

(3) LOCK OFF THE NON-DRIVE END SHAFT USING A POZI SCREWDRIVER, ENSURING THAT THE LOCKING COLLAR IS TIGHT AGAINST THE BARREL.

AXLE ASSEMBLY

(4) With the non-drive end engaged into the safety brake and the locking collar secured, align the motor mounting plate making sure the override position is at the required point - 45° for Somfy and Econom motors (except for external override - vertical - see separate instructions supplied with the external override). Secure the mounting plate using four self-tapping screws (attached to the barrel).

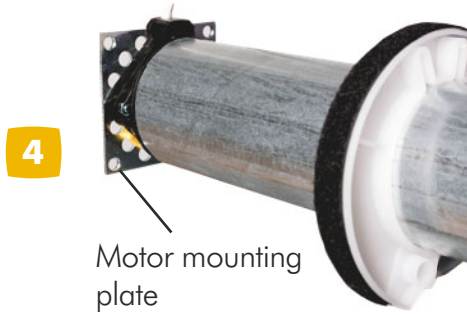

Fit the motor mounting plate, ensuring the override is correctly aligned as below.



Please note: on 360mm boxes the override position is always vertical.

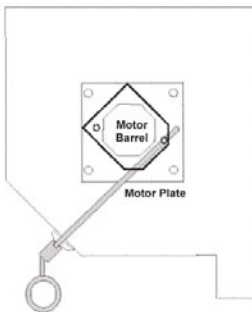

Correct motor position 45° override position for Somfy (except for external override - vertical - see separate instructions supplied with the external override).

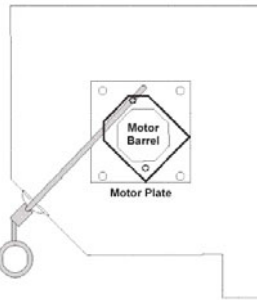

Correct motor position 45° override position for Econom (except for external override - vertical - see separate instructions supplied with the external override).

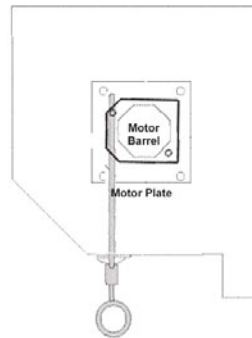

Correct motor position vertical override position 360mm box

IMPORTANT - Check the override position of the motor to ensure it exits the headplates as shown in the three diagrams.



PREPARING THE HEAD PLATES

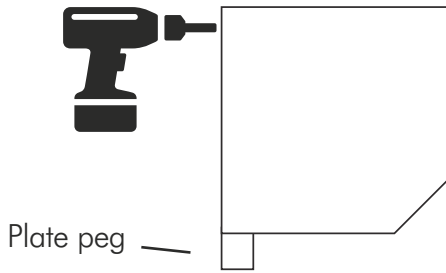

Head plates will be pre-drilled with 1 x fixing hole each. Head plate will require 2 x fixings to secure via the reinforced tabs. Use appropriate fixings to secure the head plates to the wall.

FIXING THE DOOR GUIDES & HEAD PLATES

Slide the peg on the head plate into the box channel of the guide. Note: The lugs in the channel help to ensure the head plate rests neatly against the head and in the correct position - see guide orientation section on page 10. Lift into position against the opening.

Hold guides in place using quick clamps. Check the level of the guides, both vertically and horizontally. If the floor is not level it will be necessary to pack the bottom of the guide on the low side to ensure guides are horizontally level.

IMPORTANT: It is important that your floor is level to achieve an effective seal and ensure proper operation of safety edge over time. The door cannot be fitted off level to compensate for uneven floors.

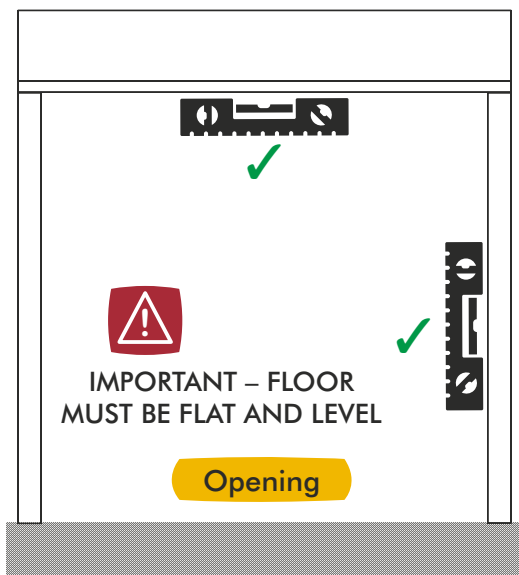

 ENSURE FIXINGS ARE SUITABLE FOR THE GARAGE WALL BUILD PROPERTIES



If the half box or full box option has been selected the axle can be assembled on the floor before lifting the guides and head plates into position.

Once guides are positioned correctly secure to the wall with fasteners using a central fixing hole. Check levels again and when guides are level both vertically and horizontally, secure to wall using appropriate fixings in the remaining fixing holes.

Note: Do not over tighten to compensate for irregularities in the wall – instead pack wall where necessary.

Secure the head plate to the wall using appropriate fixings through the pre-drilled fixing holes. Additional fixings may be required depending on the structural integrity!

MONKEY FUR PLACEMENT

Where the optional 90° box is being fitted it will be necessary to secure to the head to prevent any marking of the door curtain while in operation. Ensure any fixing used is countersunk and that screw heads do not protrude to avoid damage to door curtain. You have the option to fit the supplied monkey fur at this point to cover the screw heads. **Please Note:** The primary function of the monkey fur is to protect the door curtain from the screw heads. It may also aid draught proofing but this is not its primary function. The monkey fur may lead to curtain marking over time, this is not considered warranty.

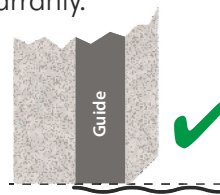

Fit base of guide level with the highest point of the floor surface

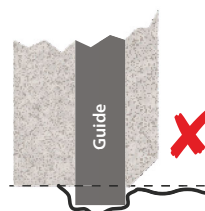

DO NOT fit guide in recess left by removal of timber frame

INSTALLING THE INTERNAL MANUAL OVERRIDE



When you are ready to install the 45° box you will need to mark and notch out the endplate, then drill a hole through the box to allow insertion of the knuckle override shaft to locate into the motor.

Secure the knuckle to the box with the fixings provided.



Please note: on 360mm boxes the override position is always vertical.



Notch the endplate



Drill the box



Secure the Knuckle



If a 45° box is not fitted, secure the knuckle to the endplate flange.

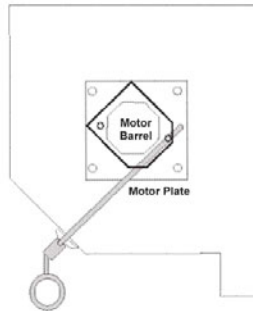

Correct motor position 45° override position for Somfy (needs to be secured with No.3 Allen bolt and washer)

(except for external override - vertical - see separate instructions supplied with the external override).

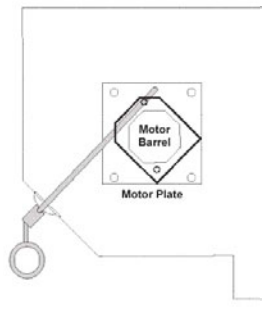

Correct motor position 45° override position for Econom (needs to be secured with Phillips screw and washer)

(except for external override - vertical - see separate instructions supplied with the external override).

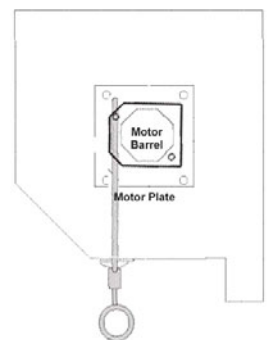

Correct motor position vertical override position 360mm box



ATTACH THE CORRECT MANUAL OVERRIDE CRANKING DIRECTIONAL ARROW LABELS TO THE 45 DEGREE BOX OR DOOR GUIDE (IF NO BOX OR HALF BOX FITTED).

INSTALLATION OF CURTAIN INTO GUIDES AND FITTING OF STOPS

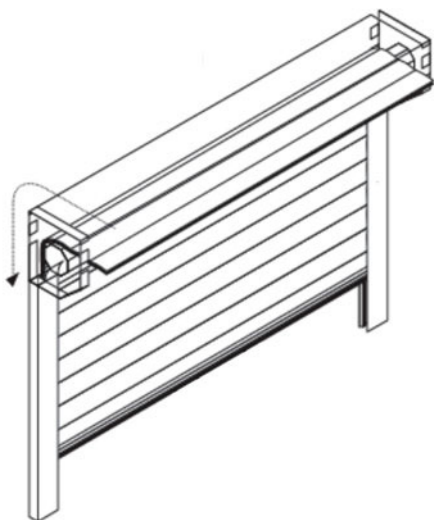

1. Cover the barrel and rings with the protective bubble wrap from the curtain.
2. Lift coiled curtain up level with axle (requires 2 people) and feed the safety edge terminal block over the barrel, then feed the bottom of the curtain over the barrel into guide.
3. Slowly unroll curtain and gently lower down to floor. NB Do not allow the curtain to free fall over the axle as this will result in damage to the curtain.
4. Fit conical stops to bottom slat.

INSTALLATION AND CONNECTION OF BOARD

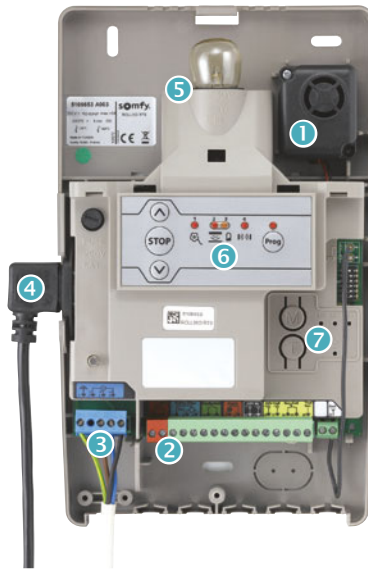

- ① Alarm sounder
- ② Plug-in connectors for accessories
- ③ Plug-in motor connector
- ④ Quick plug-in mains supply cable
- ⑤ Courtesy light
- ⑥ LED diagnostic interface
 - motor & safety brake
 - safety edge
 - photo-cells
 - low battery
- ⑦ Functional mode setting
 - standard operating mode
 - auto time return mode

Rollixo RTS control panel

No.	Description
1	Up button
2	Stop button
3	Down button
4	Prog button
5	Prog LED
6	Motor & safety brake LED
7	Safety edge LED
8	Battery LED
9	Photocell LED

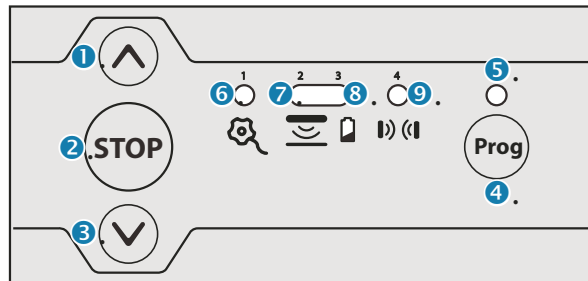

Mounting the Rollixo RTS

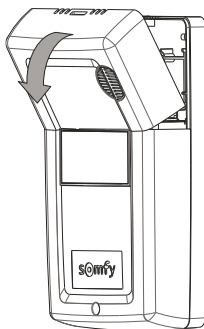

① Remove the courtesy light cover.

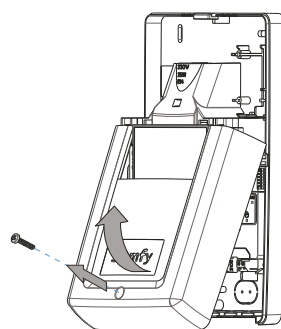

② Unscrew and remove the panel cover.

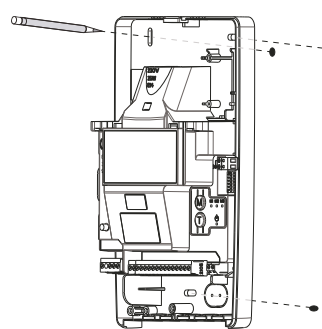

③ Mark the wall drilling positions, set box aside & drill 3 holes.

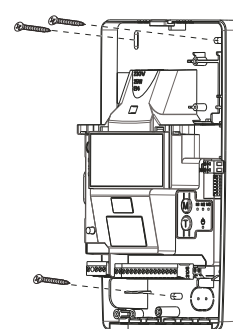

④ Secure the Rollixo RTS in place.

SOMFY ROLLIXO QUICK COMMISSIONING

Rollixo RTS Solutions

This quick guide provides basic installation and commissioning guidance based on the Somfy Rollixo RTS controller and safety edge solutions. Refer to the main Rollixo RTS controller and safety edge installation guides where more in-depth information relating to the installation procedure of the Rollixo RTS system is required.

Additional steps must be taken to ensure the straight edge of the door meets with the straight edge of a floor extending into the guides, especially when removing posts - holes must be filled level with the floor. Failure to do so will result in; air + light gaps, false activations of the safety edge etc.

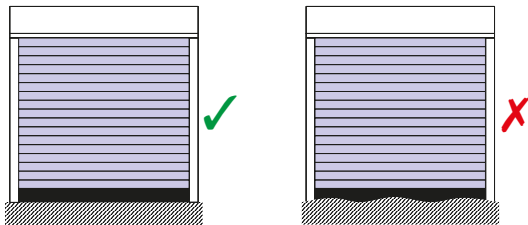

Somfy motor wiring

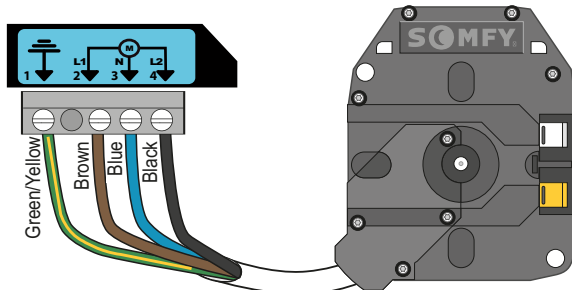

- 1 Connect the motor wires into terminals 1, 2, 3 & 4 as illustrated above.

Note: The motor direction can be reversed during the commissioning procedure.

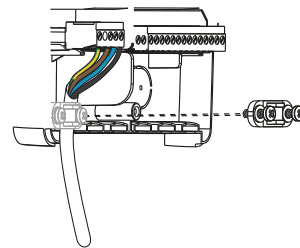

- 2 Secure the motor supply cable in place with the cable clamp.

SOMFY ROLLIXO QUICK COMMISSIONING

Safety brake jumper

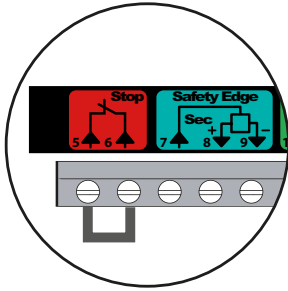

The safety brake jumper is pre-fitted to terminals 5 and 6.

- 1 Use the link provided to connect terminals 5 & 6

Hard wired safety edge connection

IMPORTANT! Make sure you connect the pre-wired green terminal block before bringing power to the control board.

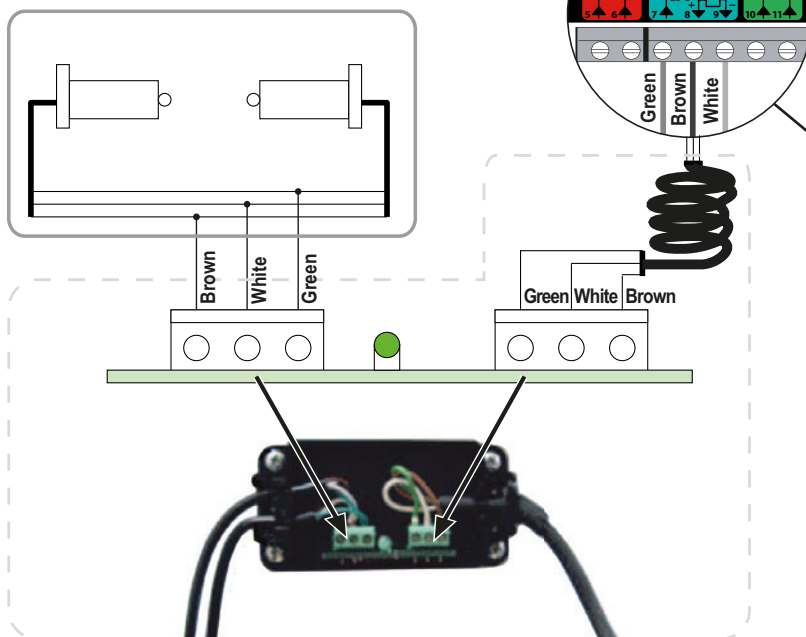

The cable connects via a plug-in connector block, (this comes pre-wired).

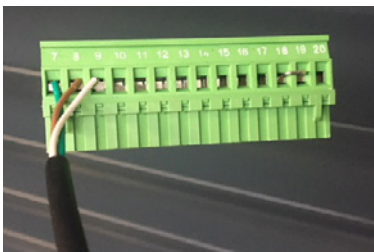

Pre-wired block



Control panel connector

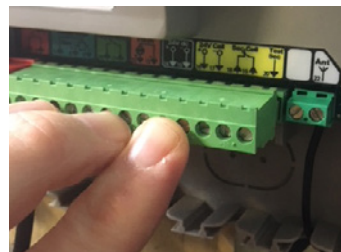

Push to fit



Pre-wired block in place

SOMFY ROLLIXO QUICK COMMISSIONING

Powering up the Rollixo RTS

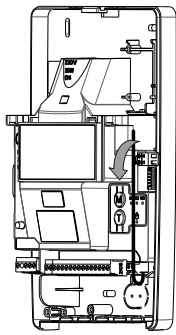

- 1 Unfold the aerial so that it points vertically downwards.

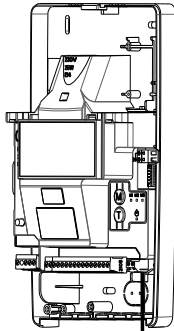

- 2 Screw the bulb supplied into the light fitting.

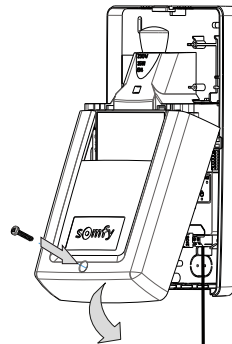
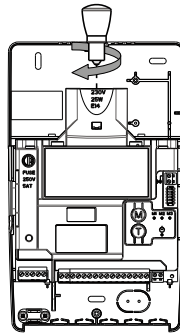

- 3 Refit the panel cover and secure with the screw.

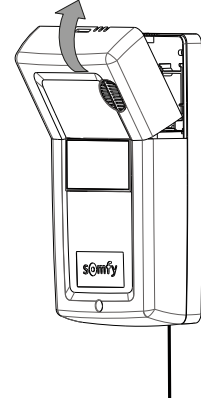

- 4 Refit the courtesy light cover.

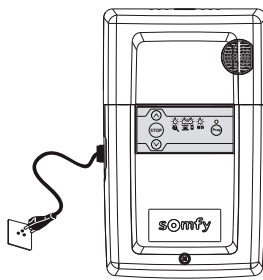
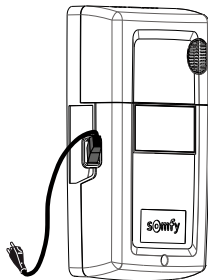

- 5 Plug in the supply cable and connect the the mains supply.

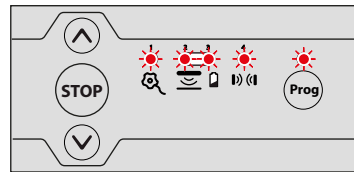

All the LED's come on briefly and then go out.



If the motor LED comes on, check the safety brake or link connection.



If the safety edge LED comes on, this may be due to plugging the terminal block in after power was switched on. To restore, switch power off and on

SOMFY ROLLIXO QUICK COMMISSIONING



FOR ECONOM MOTOR COMMISSIONING PLEASE GO TO PAGE 21

Motor direction

- 1 Remove yellow top limit switch cover. Press the motor limit buttons IN to allow the motor to rotate during the direction and limit setting procedure.

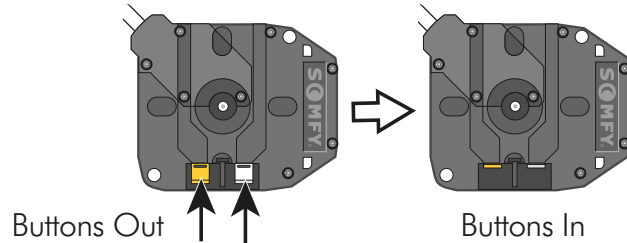

- 2 Press and hold the UP & DOWN buttons (⬆️⬇️) on the control panel until the barrel jogs up AND down, then release the buttons - the controller is now in 'motor adjustment mode', the motor LED light will flash slowly.

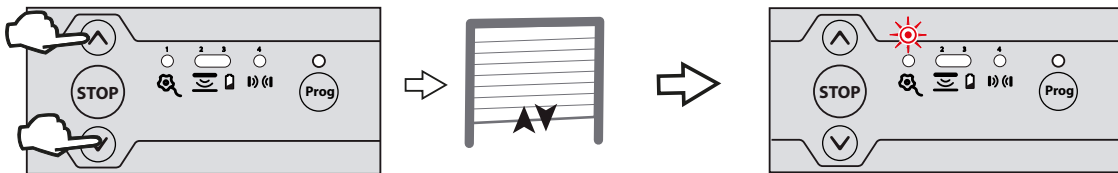

In motor adjustment mode, the Up (⬆️) & Down (⬇️) control buttons are 'hold to run' mode - you must press and hold the respective button in to operate the door up and down.

- 3 Press and hold the UP button to check the motor direction

If the motor direction is correct, connect the curtain as shown on the facing page.

If the motor direction is incorrect press and hold the STOP button until the door jogs up and down > the direction has been reversed > check again and connect the curtain as shown on the facing page.

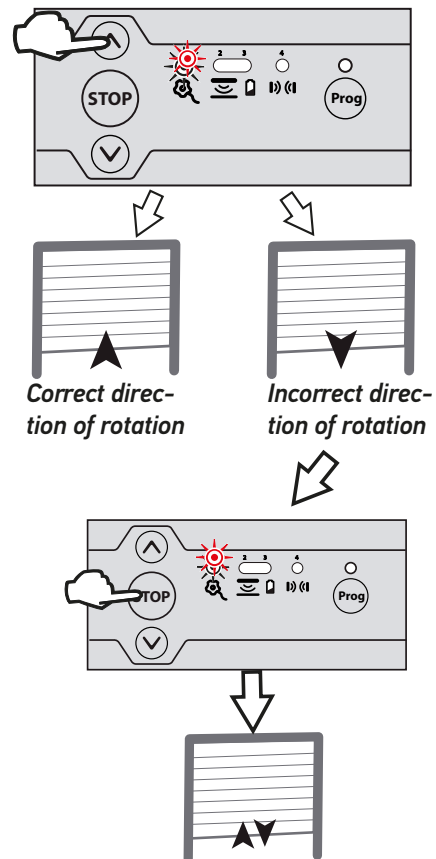

SOMFY MOTOR - ATTACHING CURTAIN TO AXEL

1) Loosen the sliding lock clips.



2) Remove the connecting pin that is pre-installed within the ring.



3) Aligning the locking strap with the lock ring hole and insert the connecting pin.



Align the locking strap with the lock ring hole.

Secure with the connecting pin provided.

4) Secure the sliding lock clips against the connecting pin.

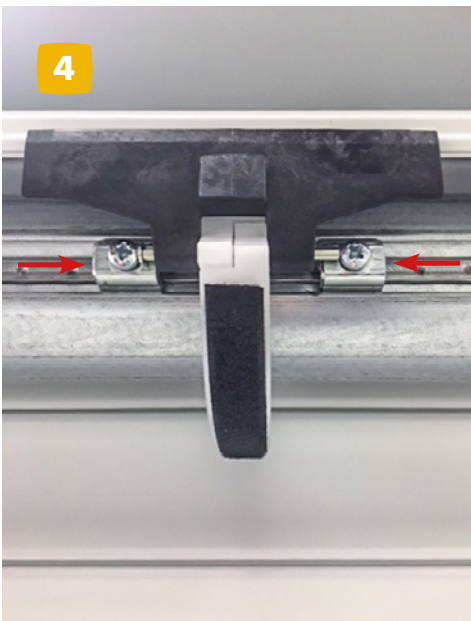

SOMFY ROLLIXO QUICK COMMISSIONING

Motor limit setting

★ During the limit setting procedure, the Rollixo push button controls are in HOLD TO RUN mode.

1 Motor limit directions as viewed from back of door

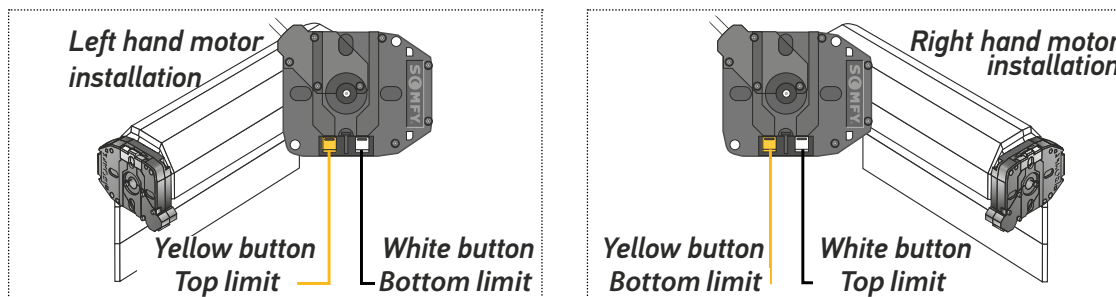

2 Fine tuning the bottom limit

Press and hold the DOWN button to move the door to the desired 'bottom limit' position (use the UP & Down buttons to fine tune the door to the desired position).

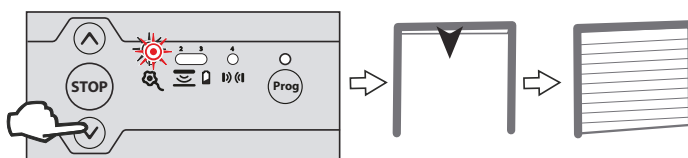

3 Press the motor 'bottom limit' button IN to release out to set the 'bottom limit' position (see diagrams to the right). To check, run the door up 200-300mm and return to check 'bottom limit' has been accepted.

Left hand motor

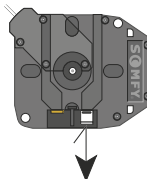

Right hand motor

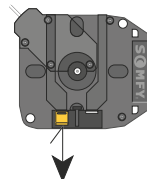

4 Setting the top limit

Press and hold the UP button to move the door to the top limit position (use the UP & Down buttons to fine tune the door to the desired position).

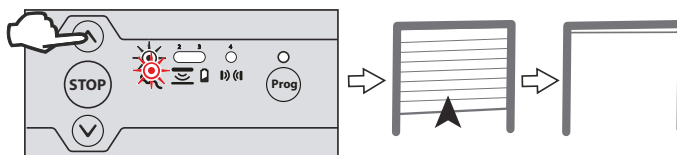

IMPORTANT: at the top limit position the bottom lath should be completely within the guide.

5 Press the 'top limit' button in, ensuring the limit button is fully out, to set the 'top limit' position (see diagrams to right). To check, run the door down 200-300mm and return to check 'top limit' has been accepted.

Left hand motor

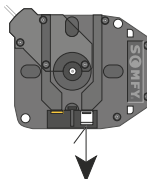

Right hand motor

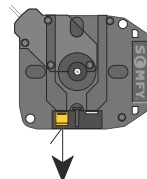

6 Briefly press the PROG button until the door jogs to complete the motor set up procedure

The motor & safety brake LED goes out.

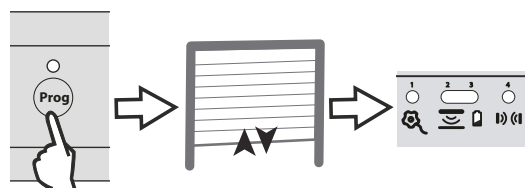

FITTING THE 45° COVER

The optional 45° cover can be installed once the motor limit setting is complete. The 45° box hooks into the 90° degree box along the join. Fix in place using self drilling screws supplied.



ECONOM MOTOR LIMIT SWITCH ADJUSTMENT

LIMIT SETTING FOR PROGRESSIVE LIMIT MOTORS (ECONOM)

Limit setting of progressive limit motors can be achieved by putting the Rollixo control board in to 'motor adjustment mode', or by use of a test lead connected to the motor.

Identify on the motor head which switch is used to set the open and closed limit position. Please note that the straight arrow beside each switch indicates the direction of travel of the barrel as it passes that point.

It is recommended not to connect the curtain to the barrel until the motor has been run to the lower stop position. Doing this will ensure the motor does not overrun and damage either the curtain or locking straps.

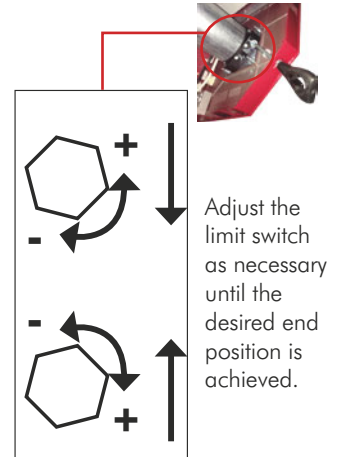

PUTTING ROLLIXO INTO ADJUSTMENT MODE

After pressing limit button in press and hold the UP & DOWN buttons on the control panel until the door jogs up AND down, then release the buttons - the controller is now 'motor adjustment mode', the motor LED light will flash slowly.

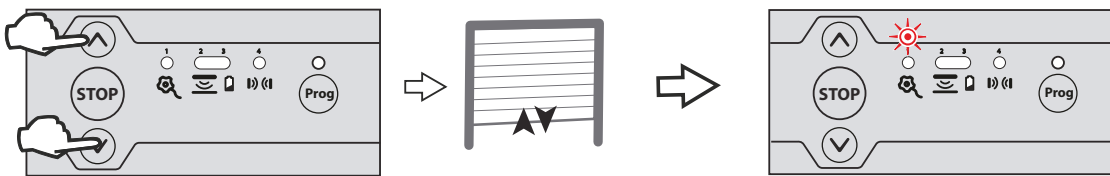

In motor adjustment mode, the Up & Down control buttons are 'hold to run' mode - you must press and hold the respective button in to operate the door up and down.

SETTING 'BOTTOM LIMIT'

With the Rollixo control board in 'motor adjustment mode', press and hold the down button, check that the motor barrel is travelling in a downward direction. Keep the down button pressed until the motor stops on its own.

If the motor direction is incorrect press and hold the STOP button until the door jogs up and down > the direction has been reversed > check again.

Check the position of the lock ring hole with the locking strap, if the motor needs to travel more to make the connection possible then adjust the appropriate switch to the positive direction, 1 complete turn of the switch equates to approx. 12mm of travel. This must be verified and large numbers of turns at a time are not recommended. Press and hold the down button to check motor position and repeat process if necessary.

If the motor has gone past the point of easy connection, press the up button on the control board to bring the motor above the desired point, then turn the appropriate switch to the negative direction. Press the down button on the control board and repeat as necessary until the desired end position has been achieved.

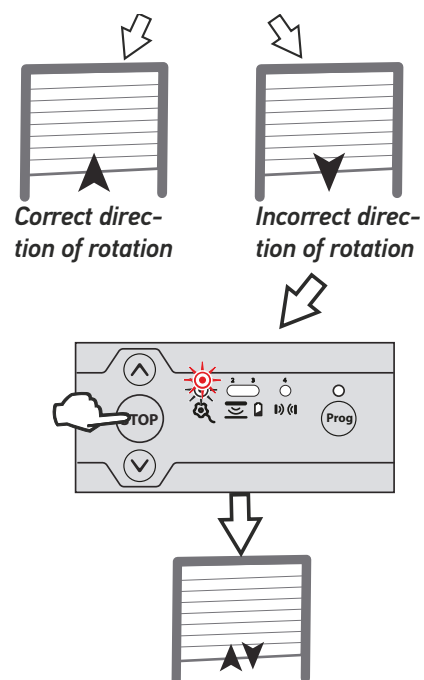

ECONOM MOTOR LIMIT SWITCH ADJUSTMENT

CONNECT THE CURTAIN TO THE MOTOR BARREL

- 1) Loosen the sliding lock clips.
- 2) Remove the connecting pin that is pre-installed within the ring.
- 3) Aligning the locking strap with the lock ring hole and insert the connecting pin.



Align the locking strap with the lock ring hole.

Secure with the connecting pin provided.

- 4) Secure the sliding lock clips against the connecting pin.



SETTING 'TOP LIMIT'

Once the bottom limit has been set, press and hold the up button on the rollixo control panel/test lead if the door stops on its own before reaching the desired open position, turn the appropriate limit screw in the positive direction, 1 complete turn of the switch equates to approx. 12mm of travel. This must be verified and large numbers of turns at a time are not recommended. Press and hold the up button to check motor position and repeat process if necessary.

If the motor does not stop within 6 inches of the desired open position stop the operation, press the down button to bring the motor approx. 12 inches below the desired stop position turn the appropriate open limit screw to the negative position, press the up button again and repeat as necessary until the door does stop at least 6 inches below the desired stop position. Once this has happened turn the appropriate limit screw to the positive and press and hold the up button, repeat as necessary until you have reached the desired up/open position.

IMPORTANT: at the top limit position the bottom lath should be completely within the guide.

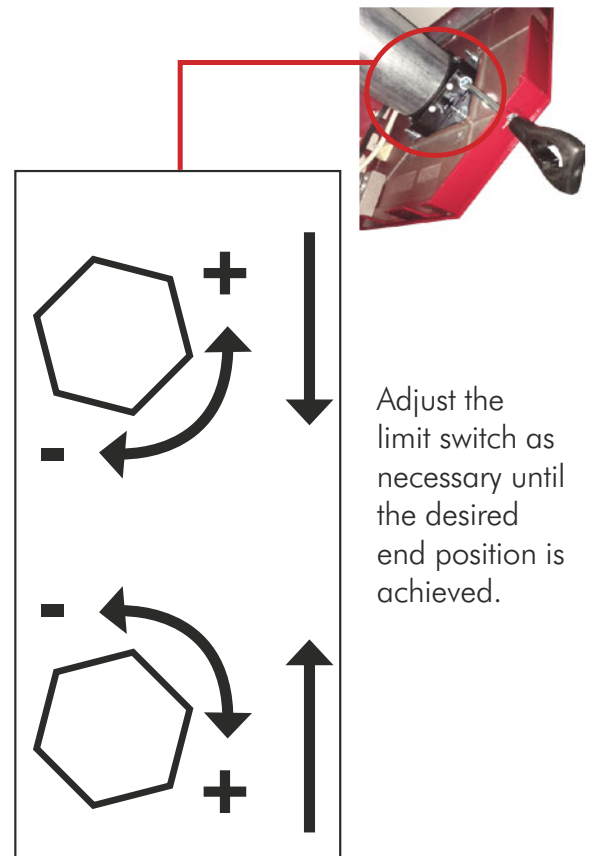

ECONOM MOTOR LIMIT SWITCH ADJUSTMENT

EXIT SET-UP MODE

Briefly press the PROG button until the door jogs to complete the motor set up procedure.

The motor & safety brake LED goes out.

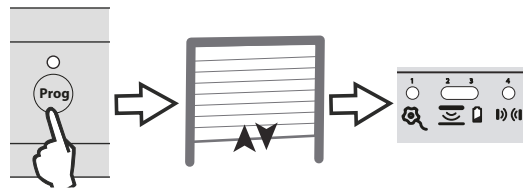

FITTING THE 45° COVER

The optional 45° cover is installed once motor limit setting is complete. The 45° box hooks into the 90° box along the join.

To fit the knuckle override, mark and notch out the endplate, then drill a hole through the box to allow insertion of the knuckle override shaft to locate into the motor.

Fit the 45° box and fix in place using self drilling screws supplied, locate the override shaft into the motor and secure the knuckle to the box with the fixings provided.

If a 45° box is not fitted, secure the knuckle to the endplate flanges.



Notch the endplate



Drill the box



Secure the Knuckle



If a 45° box is not fitted, secure the knuckle to the endplate flange.



SOMFY ROLLIXO QUICK COMMISSIONING

Pairing Keygo RTS keyfob's (supplied paired)

- 1 Press the 'Prog' button on the Rollixo RTS front panel until the LED above the Prog button lights up RED.

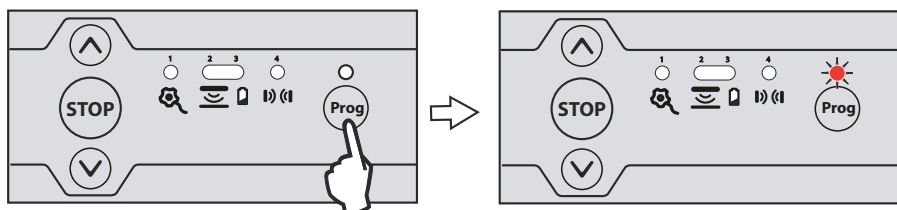

- 2 Press the button on the Keygo RTS keyfob that you want to control the Rollixo RTS controller with until the 'Prog' LED on the Rollixo RTS controller flashes and then goes out.

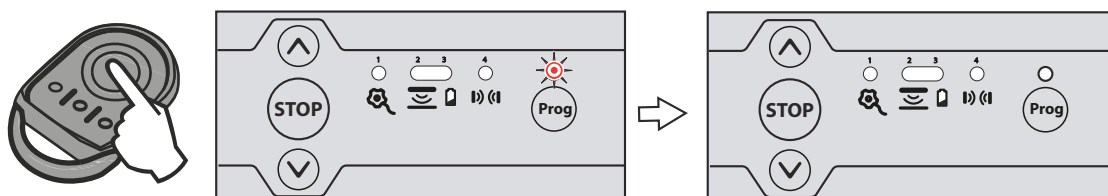

SOMFY ROLLIXO QUICK COMMISSIONING

Activating/Deactivating the alarm

The alarm function is factory set to activated. To activate/deactivate the alarm, simultaneously press the STOP and down buttons on the control panel until the 4 indicator lights flash rapidly. The alarm emits a beep if it has been activated.

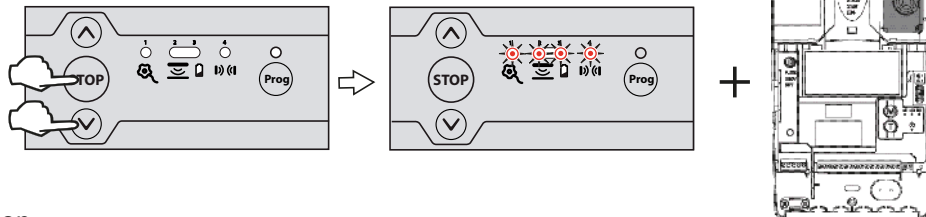

Alarm operation

The alarm is triggered for 2 minutes if the bottom rubber seal is compressed when the door is at its closed position. No movement of the door is possible when the alarm is sounding. When the alarm sounds, press a button on a remote control memorised in the receiver to stop it. The alarm can only be stopped with a memorised remote control.

Alarm operation test

Keygo transmitter required. With the door closed compress the bottom rubber seal. The alarm will sound, use pre-programmed button on handset to turn alarm sounder off. If the alarm doesn't sound it has been de-activated. Reactivate using stop and down buttons as above.

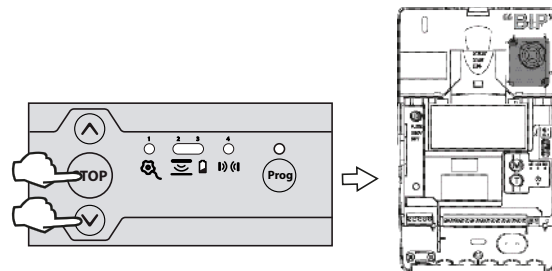

Locking out the Panel

- 1 Press buttons **STOP** and **Prog** simultaneously on the control panel until all the indicator lights flash.

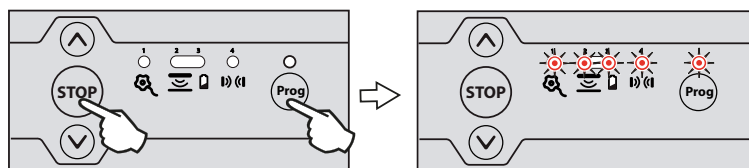

- 2 Entry into programming mode by pressing button **Prog** on the receiver is locked.

Entry into motor end limit setting mode via pressing buttons **Up** and **Down** on the receiver is locked.

The parameter setting of the operating modes is locked, the reverse process applies to UNlock the panel - ie hold/stop programme.

Failure to do so will enable consumer to operate programming mode, this is potentially dangerous.

SOMFY ROLLIXO QUICK COMMISSIONING

Deleting all remote controls from the memory

- Press the 'Prog' button on the Rollixo RTS front panel for approximately 7 seconds until the LED goes out:

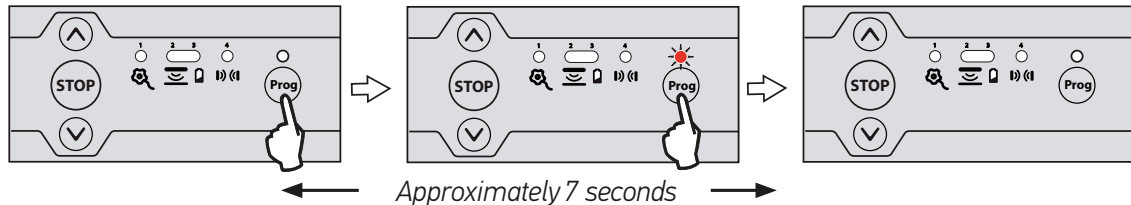

The LED will then begin to flash slowly and then go out - all remote controls have been deleted.

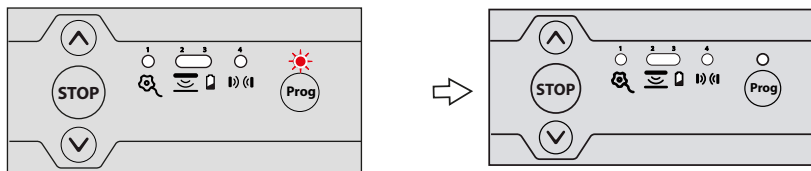

Holiday mode

- Activating/deactivating holiday mode

The door must be closed to activate this mode

To activate/deactivate holiday mode, press the **STOP** button until the 4 indicator lights flash rapidly for 2 seconds.

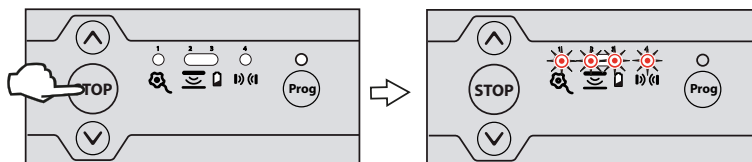

When holiday mode is active, each time a programmed control (control panel interface or remote control) is pressed, indicator lights 1,2,3 and Prog start flashing for 2 seconds

Holiday mode parameter setting

	ON	OFF	Comments
Dipswitch 5 Holiday mode		X (default setting)	Programming Interface locked (remote controls and keyswitch active)
	X		Remote controls locked (programming interface and keyswitch active)

SOMFY ROLLIXO QUICK COMMISSIONING

CONNECTING ADDITIONAL DEVICES

General wiring diagram

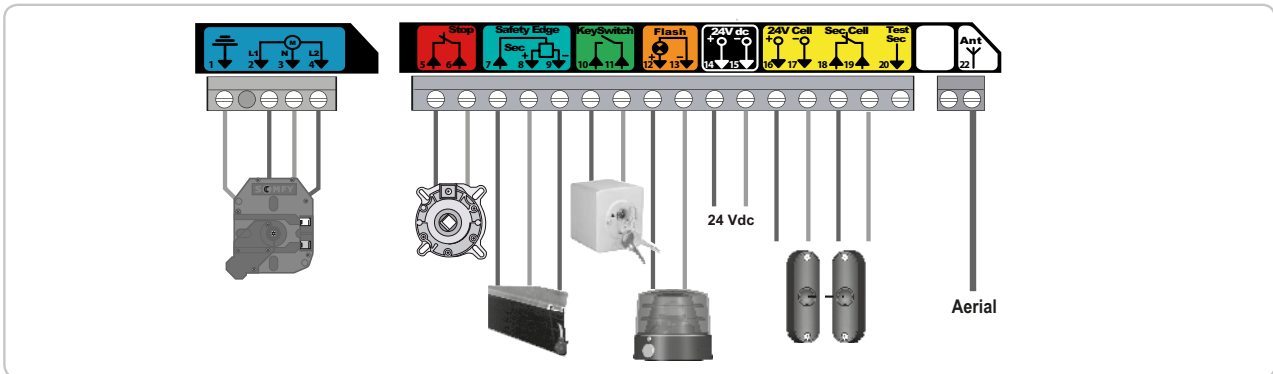

Terminal	Type of terminal	Connection	Comments
1	Earth		
2	L1	RDO CSI 50 or 60 motor	
3	Neutral		
4	L2		
5	Contact	Fall protection - NC contact	
6	Shared		
7	Contact	Safety edge safety input	Wired resistive safety edge (terminals 7 - 8)
8	12 Vdc		
9	0 Vdc	12 Vdc safety edge power supply	Wired optical safety edge (terminals 7 - 8 - 9)
10	Contact	NO contact	
11	Shared		
12	24 Vdc	24V - 3.5 W orange light output	Maximum 4 W bulb
13	0 Vdc		
14	24 Vdc	TX cell 24 V power supply	Transmitting photoelectric cell/Reflex photocell power supply
15	0 Vdc		
16	24 Vdc	RX cell 24 V power supply	Receiving photoelectric cell power supply
17	0 Vdc		
18	Shared	Cell safety input (NC)	
19	Contact		
20	Test output	Cell safety test output	Reflex photocell self-test
22		433.42 MHz aerial	Do not connect an offset aerial (incompatible)

Parameter setting for wiring options

Dipswitch	Possible parameter setting	ON	OFF
1	Cell self-test	Activated	Deactivated
2	Choice of cell type	Photoelectric	Reflex photocell
3	2-second orange light warning	Activated	Deactivated
4	Choice of wired safety edge type	Resistive	Optical
5	Alarm operation	Activated	Deactivated
6	Do not use		

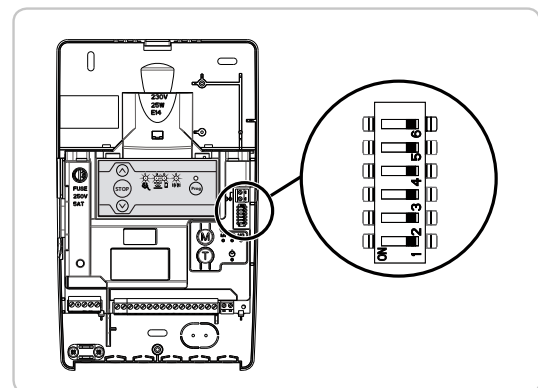

SOMFY ROLLIXO QUICK COMMISSIONING

Complete Check List

- Is the floor level?

- Top & Bottom limits set?

- Up, Stop & Down working correctly with Courtesy light?

- Does safety edge activate when it hits an obstruction?

- When closed is the rubber edge uniform and not deformed?

- Is the Alarm active?

- Do all the accessories and Key fobs work correctly?

- Have you locked out the panel?

- End User Demonstration?



PREVENT CURTAIN DAMAGE!



THE DOOR CURTAIN MUST RUN CLEAR OF THE LINTEL TO AVOID CURTAIN MARKING.



LINTELS ARE OFTEN UNEVEN OR BOWED AND MAY CONTAIN ELEMENTS OF PROTRUDING CONCRETE.

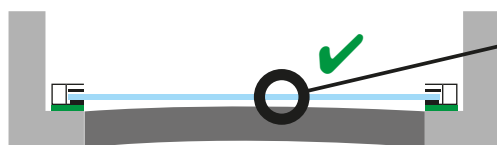

A MINIMUM OF 5MM CLEARANCE IS RECOMMENDED OVER THE MOST PROTRUDING PART OF LINTEL TO DOOR CURTAIN



TEMPERATURE CHANGES MAY CAUSE THE DOOR CURTAIN TO DEFLECT. SUFFICIENT LINTEL CLEARANCE MUST BE ALLOWED TO MITIGATE THIS EVENTUALITY.

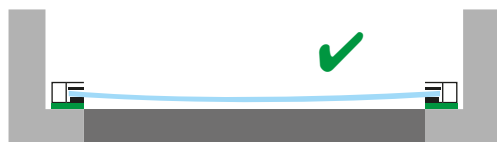

TOP TIP: MANY INSTALLERS USE PVC STRIP OR PACKERS TO SPACE GUIDES & HEADPLATES OFF THE WALL TO ENSURE THE CURTAIN DOES NOT CONTACT ANY POINT OF THE LINTEL DURING TRAVEL.

FAILURE TO ENSURE PROPER CLEARANCE AT INSTALLATION OR DURING SUBSEQUENT OPERATION WILL RESULT IN CURTAIN MARKING AND WILL NOT CONSTITUTE WARRANTY.

BETWEEN FIX



IF YOU ARE FITTING BETWEEN THE REVEAL UNDER A LINTEL, THE BOX WILL NEED EXTRA SUPPORT TO ENSURE CONTACT WITH THE CURTAIN DOES NOT OCCUR.

BOX SUPPORTS ARE AN AIDE TO KEEP THE BOX FREE FROM THE CURTAIN BEHIND A SUPPORTED LINTEL. THEY ARE NOT SUFFICIENT TO SUPPORT AND PROTECT THE BOX UNDER A LINTEL.

TOP TIP: MANY INSTALLERS USE A TIMBER HEADER ACROSS THE SPAN OF THE OPENING AT THE TOP AND COVER WITH PVC AS A POSSIBLE SOLUTION.

THE BOX SHOULD BE SUPPORTED AT THE FRONT AS MUCH AS POSSIBLE WITH THE AMOUNT OF EXPOSED BOX NOT EXCEEDING 100MM.

TROUBLESHOOTING GUIDE

DESCRIPTION OF FAULT	DIAGNOSIS	POSSIBLE CAUSE	SOLUTION
Door will only close in dead man mode	Control panel number 2 light will be illuminated indicating that no light is detected through the rubber.	Is the bottom rubber crushed? Are any of the guides set into a hole? Is the threshold uneven?	Resolve the issue that is preventing the bottom rubber from transmitting the light beam.
Alarm is not sounding	When the door is at the bottom limit and the rubber is compressed the alarm should sound for 2 minutes unless cancelled with one press of a key fob button.	The control unit has not been issued with the Alarm factory set	The alarm should be pre-set to "on" as standard. To disarm, press and hold the down (v) button and (STOP) button simultaneously, until all lights on the control unit flash and then release the buttons. The alarm is now deactivated. Carry out the same procedure to reactivate.
The control unit is not responding	Although the unit is not responding, can you hear the control unit click when trying to execute an up or down command? On the control unit does the red motor light (1st light) flash? If trying to send a command from a key fob do you hear a click and the motor light and Prog light flash?	Fuse blown - normal fuse failure relating to the motor or light bulb.	Replace the fuse in the black fuse holder with spare housed below.
The control unit is completely dead and no response is registering with the control.	The fuse within the plug has possibly blown and needs to be replaced.	Fuse blown - normal fuse failure.	Replace the fuse in the plug. If issue is not resolved contact GDS to advise possible faulty unit.
The door is closing on its own	Remove the front cover on the control unit and check if the red light beside the T button is on. This indicates that the auto close function is on.	Auto close has been activated.	Press the T button to deactivate the Auto Close function. The red light will go out to signify this has been cancelled.
The door only operates on the Key Fob and will not respond on the control panel	When holiday mode is active, each time a programmed control (control panel interface or remote control) is pressed, indicator lights 1,2,3 and the Prog start flashing for 2 seconds.	Holiday mode has been activated.	To activate / deactivate holiday mode press the "STOP" button until the 4 indicator lights flash rapidly for 2 seconds.



**YOUR SAFETY
FIRST!**

Read this booklet
carefully before
installing your door



**HEAVY -
LIFT WITH
CAUTION!**



Call:
Northern Ireland: 028 2565 5555
UK 0870 242 3 242
Republic of Ireland 1850 510 510

Email: info@garagedoorsystems.co.uk
Web: www.garagedoorsystems.co.uk

Garage Door
Systems Limited,
Wakehurst Ind.
Est., Ballymena,
BT42 3AZ

Garage Door Systems operates a policy of continuous product development and reserves the right to alter specifications to product design features, product functionality, other product specifications and product manufacture without notification.

All specifications are correct at time of publication, errors and omissions excepted.

Date 11/22 Issue 1. Colours shown are for guide purposes only and are limited by the printing process.